

**vtech**<sup>®</sup>  
Baby

User's Manual

# My 1st Luggage



© 2013 VTech  
Printed in China  
91-002847-001 

**VTech understands that a child's needs and abilities change as they grow and with that in mind we develop our toys to teach and entertain at just the right level...**

## **vtech** Baby

**Toys that will stimulate their interest in different textures, sounds and colours**

### **I am...**

...responding to colours, sounds and textures

...understanding cause and effect

...learning to touch, reach, grasp, sit-up, crawl and toddle

*Birth-36months*



## **Pre-School**

**Interactive toys to develop their imagination and encourage language development**

### **I want...**

...to get ready for school by starting to learn the alphabet and counting

...my learning to be as fun, easy and exciting as can be

...to show my creativity with drawing and music so my whole brain develops

*3-6years*



## **Electronic Learning Computers**

**Cool, aspirational and inspiring computers for curriculum related learning**

### **I need...**

...challenging activities that can keep pace with my growing mind

...intelligent technology that adapts to my level of learning

...National Curriculum based content to support what I'm learning at school

*4-10years*



To learn more about this and other VTech® products, visit [www.vtechuk.com](http://www.vtechuk.com)

# INTRODUCTION

Thank you for purchasing the **VTech® My 1st Luggage** learning toy!

The **My 1st Luggage** by **VTech®** teaches your child as they travel around the world! Your little one can discover and explore different countries and their landmarks, modes of transport, basic French and it will also develop motor skills through imaginative play! Pack your bags, it's time for learning fun!

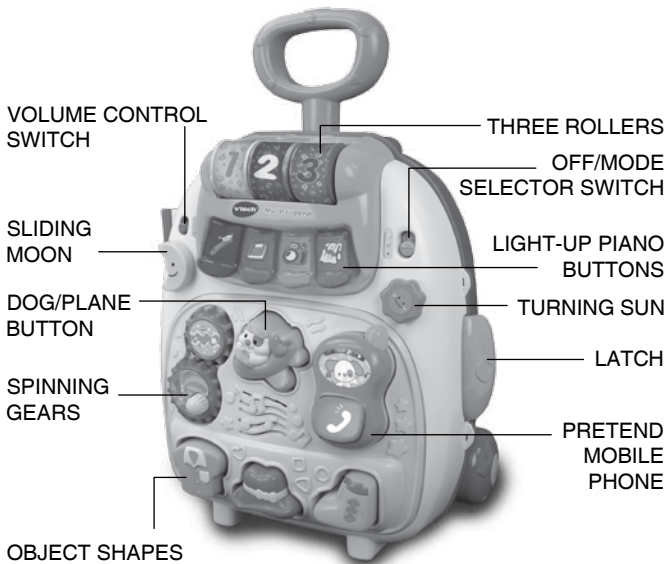

# INCLUDED IN THIS PACKAGE

- One VTech® My 1st Luggage
- Three object shapes
- Pretend mobile phone
- Handle
- One instruction manual

**WARNING:** All packing materials, such as tape, plastic sheets, packaging locks and tags are not part of this toy, and should be discarded for your child's safety.

**NOTE:** Please keep this instruction manual as it contains important information.

## GETTING STARTED

### BATTERY INSTALLATION

1. Make sure the unit is turned **OFF**.
2. Locate the battery cover inside the suitcase. Use a coin or a screwdriver to loosen the screw.
3. Install 2 new 'AA' (AM-3/LR6) batteries following the diagram inside the battery box. (The use of new alkaline batteries is recommended for maximum performance.)
4. Replace the battery cover and tighten the screw to secure.

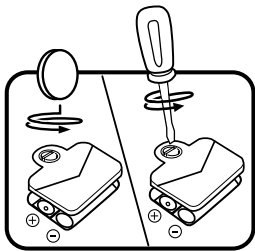

### BATTERY NOTICE

- Use new alkaline batteries for maximum performance.
- Use only batteries of the same or equivalent type as recommended.

- Do not mix different types of batteries: alkaline, standard (carbon-zinc) or rechargeable (Ni-Cd, Ni-MH), or new and used batteries.
- Do not use damaged batteries.
- Insert batteries with the correct polarity.
- Do not short-circuit the battery terminals.
- Remove exhausted batteries from the toy.
- Remove batteries during long periods of non-use.
- Do not dispose of batteries in fire.
- Do not charge non-rechargeable batteries.
- Remove rechargeable batteries from the toy before charging (if removable).
- Rechargeable batteries are only to be charged under adult supervision.

### Disposal of batteries and product



The crossed-out wheeled bin symbols on products and batteries, or on their respective packaging, indicates they must not be disposed of in domestic waste as they contain substances that can be damaging to the environment and human health.



The chemical symbols Hg, Cd or Pb, where marked, indicate that the battery contains more than the specified value of mercury (Hg), cadmium (Cd) or lead (Pb) set out in Battery Directive (2006/66/EC).

The solid bar indicates that the product was placed on the market after 13th August, 2005.

 Help protect the environment by disposing of your product or batteries responsibly.

For more information, please visit:

[www.recycle-more.co.uk](http://www.recycle-more.co.uk)

[www.recyclenow.com](http://www.recyclenow.com)

# ASSEMBLY INSTRUCTIONS

With the **My 1st Luggage**, safety comes first.

To ensure your child's safety, adult assembly is required.

1. Please remove the label that covers the hole for the handle, then remove the plastic beneath it. Keep both out of reach of children.



2. To attach the handle to the suitcase, insert the handle into the hole on top of the suitcase. You will hear it click into place. Please ensure the handle is attached securely to the suitcase. Once the handle has been attached, it cannot be removed.



## ATTENTION!

The cord attached to the clothes shape is not part of the toy. For your child's safety, please cut and discard the cord before assembly.



The cord attached to the phone accessory is also used to keep the suitcase securely closed in the package and is not part of this toy. For your child's safety, please cut and discard the cord before assembly.

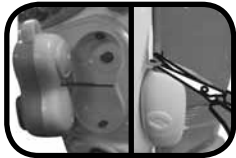

# PRODUCT FEATURES

## 1. OFF/MODE SELECTOR

To turn the unit **ON**, slide the **OFF/MODE SELECTOR** to the **Travel Mode** (✈️) or **Music Mode** (🎵) position. To turn the unit **OFF**, slide the **OFF/MODE SELECTOR** to the **OFF** (●) position.



## 2. VOLUME CONTROL SWITCH

To turn the unit **ON**, slide the **VOLUME CONTROL SWITCH** to the Low (🔊) or High (🔊) Volume position.



## 3. AUTOMATIC SHUT-OFF

To preserve battery life, the **VTech® My 1st Luggage** will automatically power-down after approximately 42 seconds without input. The unit can be turned on again by pressing any button and rolling the wheels.

# ACTIVITIES

1. Turn on the unit in **Travel Mode** or **Music Mode**. You will hear a variety of fun sounds, a sing-along song and playful phrase. The lights will flash with the sounds.
2. In **Travel Mode**, press the dog/plane button to hear about traveling to different places in the world. In **Music Mode**, press the dog/plane button to hear music. The lights will flash with the sounds.



3. **Spin the gears** to hear boat sounds in Travel Mode. Melodies will play in Music Mode. The lights will flash with the sounds.

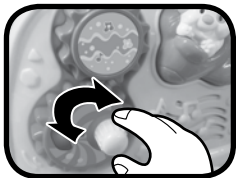

4. Pick up or hang up the **phone** in Travel Mode to learn “Hello” and “Goodbye” in French. In Music Mode, you’ll hear fun sound effects and music. The lights will flash with the sounds.

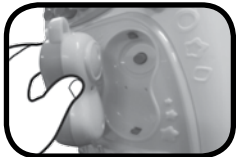

5. Press the **light-up piano buttons** to learn about things to pack in Travel Mode and to play piano notes in Music Mode. The lights will flash with the sounds.



6. Insert the **object shapes** into the correct places on the front panel to learn colours and clothes in Travel Mode. Hear music in Music Mode. The lights will flash with the sounds.



7. Spin the **rollers** to hear numbers and fun sounds in Travel Mode and melodies in Music Mode. The lights will flash with the sounds.

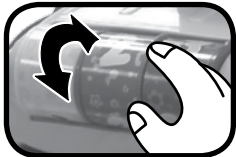



8. Turn the sun and moon to learn “Good Morning” and “Good Night” in **French** in **Travel Mode**. You’ll learn “sun” and “moon” in English in **Music Mode**. The lights will flash with the sounds.



9. Open or close the suitcase to learn “open” and “close” in English in both modes. The lights will flash with the sounds.

## MELODY LIST:

1. Jack and Jill
2. My Bonnie Lies Over the Ocean
3. London Bridge
4. Aloha Oe
5. Can Can
6. Daisy Bell
7. Oh, Dear, What Can the Matter Be?
8. Yankee Doodle
9. Humpty Dumpty
10. Mexican Hat Dance
11. This Old Man
12. I've Been Working on the Railroad
13. Twinkle, Twinkle, Little Star
14. Toyland
15. Ten Little Indians
16. Down Where The Swanee River Flows
17. Chicken Reel
18. Sailor's Hornpipe
19. Oh! Susanna
20. Bill Bailey, Won't You Please Come Home?

## SING-ALONG SONG

### Sing-Along Song 1

I'm a little traveler,  
pulling my suitcase here and there.  
I'm a great visitor,  
enjoying trips everywhere.

### Sing-Along Song 2

Open my suitcase,  
Put my things in.  
Close my suitcase,  
Won't you take an adventure with me?

### Sing-Along Song 3

I like to travel with my suitcase,  
by boat or aeroplane.  
They take me a thousand miles away!

## CARE & MAINTENANCE

1. Keep the unit clean by wiping it with a slightly damp cloth.
2. Keep the unit out of direct sunlight and away from any direct heat source.
3. Remove the batteries when the unit is not in use for an extended period of time.
4. Do not drop the unit on hard surfaces.

# TROUBLESHOOTING

If for some reason the program/activity stops working or malfunctions, please follow these steps:

1. Please turn the unit **OFF**.
2. Interrupt the power supply by removing the batteries.
3. Let the unit stand for a few minutes, then replace the batteries.
4. Turn the unit **ON**. The unit should now be ready to play again.
5. If the product still does not work, replace with a new set of batteries.

If the problem persists, please call our Consumer Services Department on 01235 546810 (from UK) or +44 1235 546810 (outside UK) and a service representative will be happy to help you.

## IMPORTANT NOTE:

Creating and developing **VTech®** products is accompanied by a responsibility that we take very seriously. We make every effort to ensure the accuracy of the information, which forms the value of our products. However, errors sometimes can occur. It is important for you to know that we stand behind our products and encourage you to call our Consumer Services Department on 01235 546810 (from UK) or +44 1235 546810 (outside UK), with any problems and/or suggestions that you might have. A service representative will be happy to help you.

**CLASS 1  
LED PRODUCT**



## PRODUCT WARRANTY



Thank you for choosing this quality product from VTech. We hope it will bring many hours of entertainment, imaginative play and learning.

1. The product detailed above is covered by a one year warranty from the date of purchase, against any defects in materials or workmanship.
2. The product may be returned to the place of purchase. Alternatively the product can be returned to VTech Electronics Europe plc (see address below), with proof of purchase, without proof of purchase no replacement will be provided.
3. VTech Electronics Europe plc will examine the product and if it is found to be defective due to faulty materials or workmanship, will replace the product at their discretion.
4. If the product covered by this warranty is damaged due to misuse, modification or unauthorised repair, or because of faulty batteries, battery discharge or incorrect electrical connections, then this warranty becomes void.
5. This warranty is personal to the original purchaser and is not transferable.
6. Breakages to the LCD screen are not covered by the warranty.
7. Returns to VTech Electronics Europe plc should include a cheque or postal order for £1.50 towards the cost of return postage and packaging.
8. Products returned to VTech Electronics Europe plc, should be addressed as follows and packed carefully to avoid damage in transit (Please do not include batteries or adaptor).  
Please include details of the fault together with your name and address.

VTech Electronics Europe plc, c/o Tablogix Limited, 200 Milton Park, Abingdon, Oxon OX14 4TA

THIS WARRANTY IS OFFERED AS AN EXTRA BENEFIT AND DOES NOT AFFECT CONSUMERS' STATUTORY RIGHTS.

This warranty is valid for the UK and Eire only. For products purchased outside the UK and Eire, please contact your local distributor or place of purchase.

